



Hydraulic Skidding Systems Industrial Inc.

P.O. Box 602, 12 Highlander Street
St. George, Brant, Ontario, Canada N0E 1N0

Tel: 519-448-3919 Fax: 519-448-4613

hydraulicsskiddingsystems@gmail.com

www.hydraulicsskiddingsystems.com



Table of Contents

Welcome to HSSI Inc.	3
JACK TRACK Systems	4
Modular Hydraulic Skidding System – 100 Ton Capacity (M100)	4
Modular Hydraulic Skidding System – 400 Ton Capacity (M400)	5
Quick Connect, Long Distance Hydraulic Skidding Systems (QC301/601 & QC501/1001)...	6
JACK ROLL Systems	7
Heavy Duty Plain Roller – 15 Ton Capacity (PR15)	7
Heavy Duty Rocking Roller – 30 Ton Capacity (RR30)	7
Low-Boy Roller – 15 Ton Capacity (LB15, LB15D)	7
Modular Guide Rails (MGR)	8
Modular Rotation Ring (MRR)	8
JACK SYNC Systems	9
Synchronized Power Unit – 10,000 PSI	9
Basic Power Unit – 10,000 PSI	9
Electric Power Unit – 10,000 PSI	9
Custom Power Units & Hose Reels	9
Additional Rigging Equipment	10
Leveling Plates (LP25, LP100)	10
Load Distribution Plates (LDP25)	10
Support Stands (SS)	10
Structural Mats (STM, SSM)	11
Support Timbers (ST)	12
Shim Kits (SK)	12
Pintle Hitch Lock (PHL2535)	12
Storage Solutions	13
Secured Outdoor Storage	13
Equipment Rental	13
Custom Projects	13

Welcome to HSSI Inc.

HSSI Inc. is proud to introduce our line of rigging products and services. JACK TRACK and JACK ROLL systems direct the move while JACK SYNC systems power the move. Specialized rigging products are available for your specific requirements.

The manufacturing process is completed in house for continuous quality control and consistency. Products are made using the highest quality materials and finishes to ensure a superior, long lasting product. We are a company that has multiple generations involved in the manufacturing and fabricating industry. Welding procedures and welders are certified to CWB Standard 47.1 which is a CSA standard recognized worldwide.

At HSSI Inc., we strive to produce quality, long lasting and user friendly products to assist you in your daily operations.

Sincerely,

Richard Bisch
President/Owner

Modular Hydraulic Skidding System – 100 Ton Capacity (M100)

The M100 system is designed and engineered for 100 Ton capacity through 4-point loading with a 4" x 4" footprint per shoe and blocking at 60" centers for optional support beams (Figure 1). Our signature puzzle lock design permits easy connection and disconnection of skid track from back to front using a “leap-frog” technique. Sections of track can remain pinned together and team lifted. Alternatively, sections of track can remain connected when using our support beams and the whole section of track can be relocated on the support beam.

Skid tracks are designed for push and pull capability (Note: pulling is at 50% capacity). The push shoe utilizes 4 points of contact when pushing or pulling. The skid tracks are zinc dichromate plated for corrosion protection and lined with stainless steel. Side guards are made of lightweight aluminum to eliminate pinch points along the side of the tracks (not shown in Figure 1). Skid shoes are equipped with a replaceable anti-friction wear pad to promote increased lifespan. Filler shoes are available (Figure 1) for loads that are cantilevered or require continuous support during relocation. Support beams are hot dipped galvanized to provide corrosion protection.

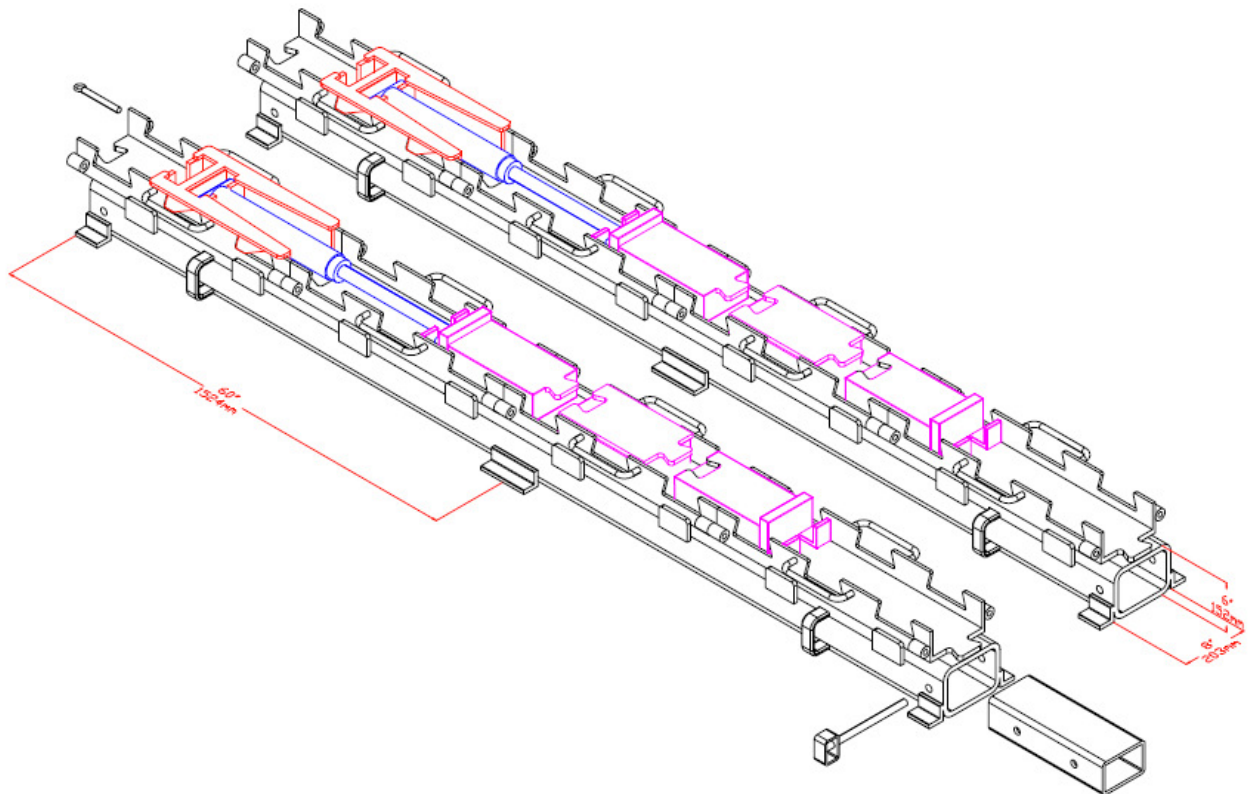

Figure 1: M100 Modular Hydraulic Skidding System (shown with optional support beams & filler shoes)

Modular Hydraulic Skidding System – 400 Ton Capacity (M400)

The M400 system is designed and engineered for 400 Ton capacity through 4-point loading with a 12" x 12" footprint per shoe and blocking at 30" centers for optional support beams (Figure 2). Our signature puzzle lock design permits easy connection and disconnection of skid track from back to front using a “leap-frog” technique. Sections of track can remain pinned together and team lifted. Alternatively, sections of track can remain connected when using our support beams and the whole section of track can be relocated on the support beam.

Skid tracks are designed for push and pull capability (Note: pulling is at 50% capacity). The push shoe utilizes 4 points of contact when pushing and pulling. The skid tracks are zinc dichromate plated for corrosion protection and lined with stainless steel. Side guards are made of lightweight aluminum to eliminate pinch points along the side of the tracks (not shown in Figure 2). Skid shoes are equipped with a replaceable anti-friction wear pad to promote increased lifespan. Filler shoes are available (shown in Figure 2) for loads that are cantilevered or require continuous support during relocation. Support beams are hot dipped galvanized to provide corrosion protection.

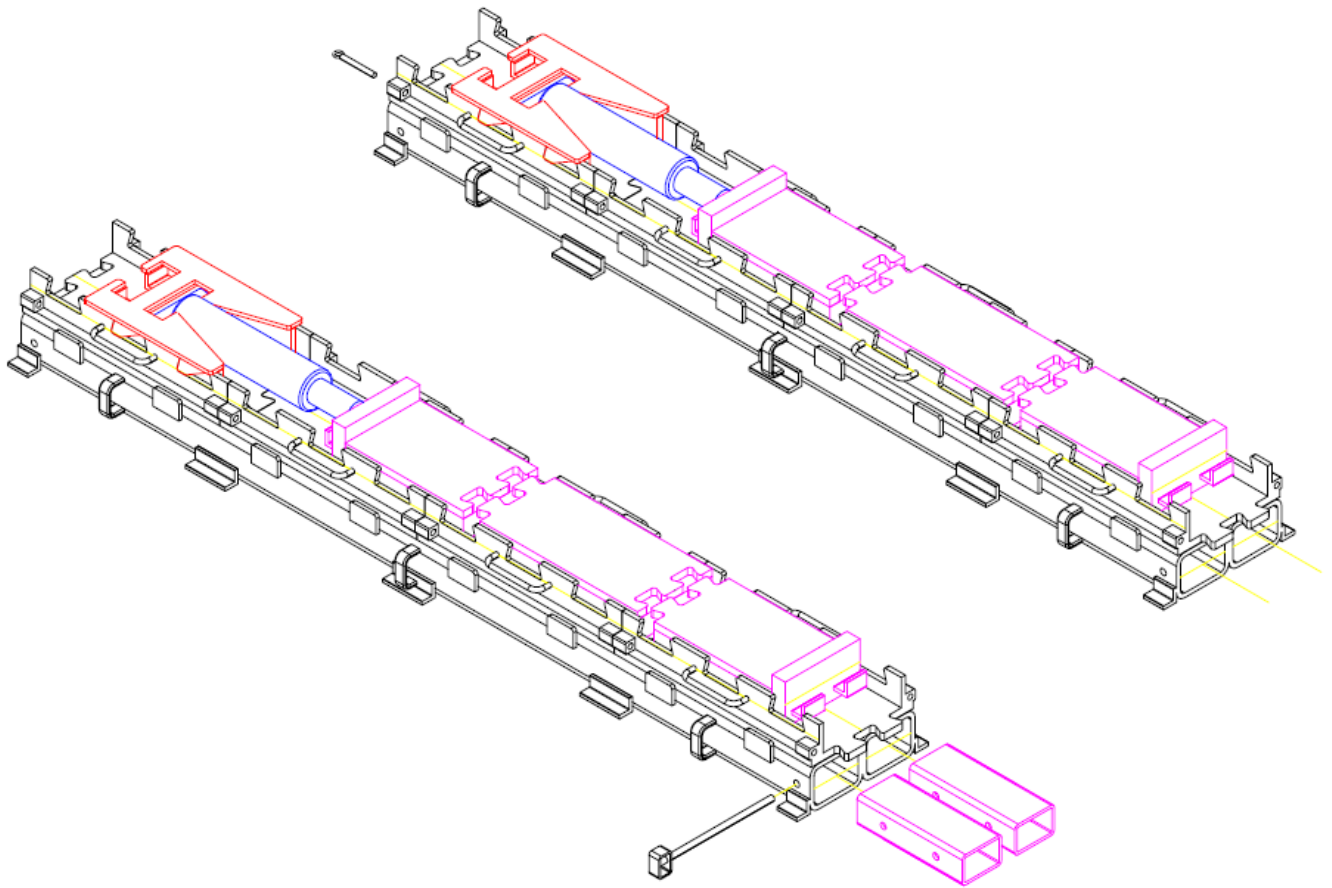

Figure 2: M400 Modular Hydraulic Skidding System (shown with optional support beams & filler shoes)

Quick Connect, Long Distance Hydraulic Skidding Systems (QC301/601 & QC501/1001)

The Quick Connect systems are designed for long distance applications. Skid track sections range from 5 ft to 18.3 ft in length. Our signature puzzle lock design permits easy connection and disconnection of skid track from back to front using a “leap-frog” technique.

Skid tracks are designed for push and pull capability (Note: pulling capacity is 50% of pushing capacity). The skid tracks are available in painted finish or hot dipped galvanized for corrosion protection. Skid shoes are equipped with replaceable wear pads to promote increased lifespan. Filler shoes are available (shown in Figure 3) for loads that are cantilevered or require continuous support during relocation.

Skid track sections can be bolted together in parallel to double the capacity of the JACK TRACK system. Additional skid shoes and hydraulic cylinders are required for this set up.

QC301: 301 Ton capacity through 4-point loading on 14" x 14" footprint per shoe (Figure 3)

QC601: 601 Ton capacity through 4-point loading on 14" x 28" footprint per shoe (using two QC301 systems' tracks bolted in parallel)

QC501: 501 Ton capacity through 4-point loading on 16" x 16" footprint per shoe

QC1001: 1001 Ton capacity through 4-point loading on 16" x 32" footprint per shoe (using two QC501 systems' tracks bolted in parallel)

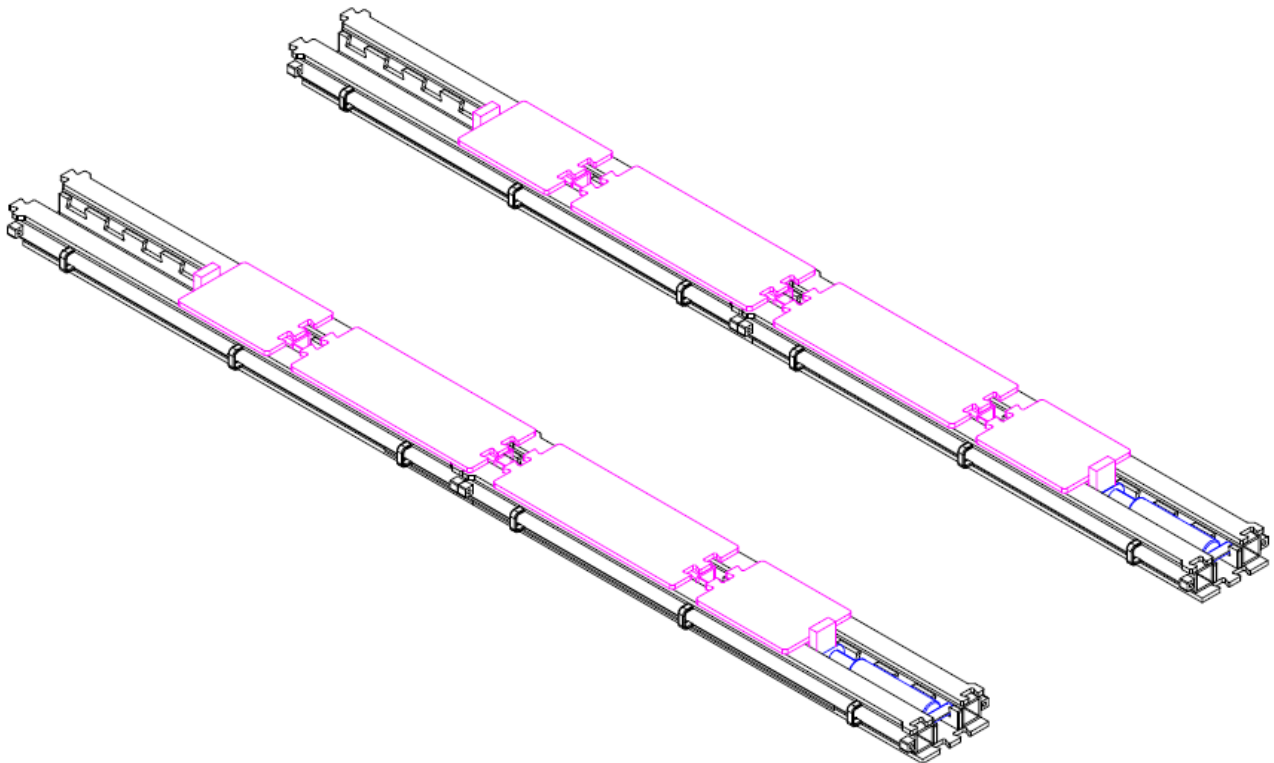

Figure 3: QC301 Quick Connect Hydraulic Skidding System (shown with optional filler shoes)

JACK ROLL Systems

HSSI Inc. Heavy Duty Rollers are engineered and designed with versatility in mind for various applications. Primarily used for launching modular bridges, they can also be used for moving other large and heavy objects or for rotating cylindrical objects on a horizontal axis (Note: custom mounting fixtures may be required). Rollers can be used in parallel and/or in sequence to increase load capacity. The 4 guide rollers are removable if not required and many parts are interchangeable between models. The sub-frame is hot dip galvanized to provide corrosion protection for a long lifespan.

Heavy Duty Plain Roller – 15 Ton Capacity (PR15)

PR15 rollers are engineered for 15 Ton capacity per roller (Figure 4).

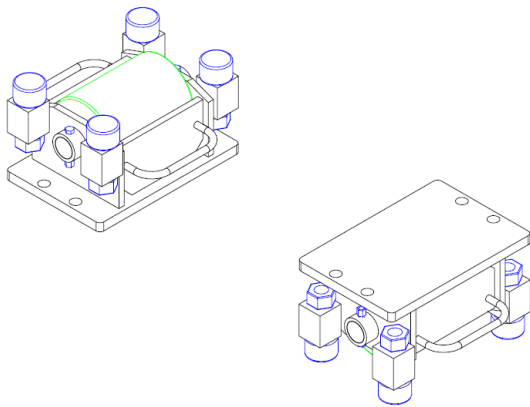

Figure 4: PR15 Heavy Duty Plain Roller

Heavy Duty Rocking Roller – 30 Ton Capacity (RR30)

RR30 rollers are engineered for 30 Ton capacity per roller (Figure 5).

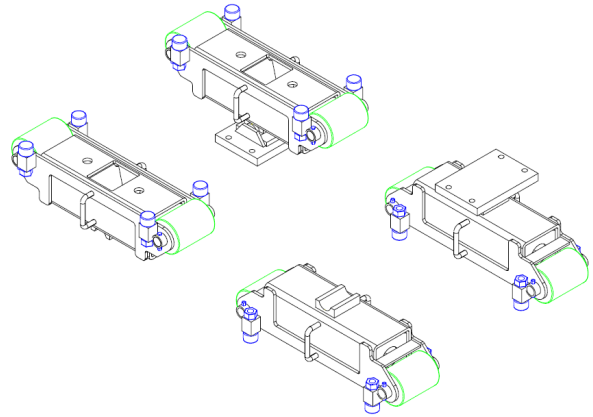

Figure 5: RR30 Heavy Duty Rocking Roller (shown with optional pivot bearing)

Low-Boy Roller – 15 Ton Capacity (LB15, LB15D)

LB15 rollers are engineered for 15 Ton capacity per roller with a low overall height (Figure 6). Our puzzle lock connection allows rollers to be easily connected in sequence. LB15D is designed specifically for use on our Modular Rotation Ring (Figure 7), which is specified to the diameter of the ring. Top plate assembly rotates 360 degrees relative to the roller.

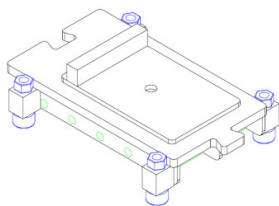

Figure 6: LB15 Low-Boy Roller

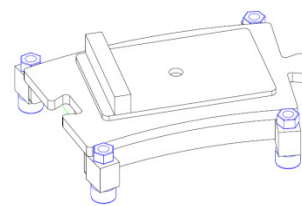

Figure 7: LB15D Low-Boy Radius Roller

Modular Guide Rails (MGR)

All of the HSSI Inc. Rollers are compatible (*other than LB15D*) for use on our Modular Guide Rails (Figure 8) to laterally move large objects. Easy connection and disconnection of guide rails is achieved through our signature puzzle lock design. Continually advance the track sections by connecting guide rails using a “leap-frog” technique. The object can be moved with on-site equipment or our JACK ROLL propulsion system which uses hydraulic cylinders.

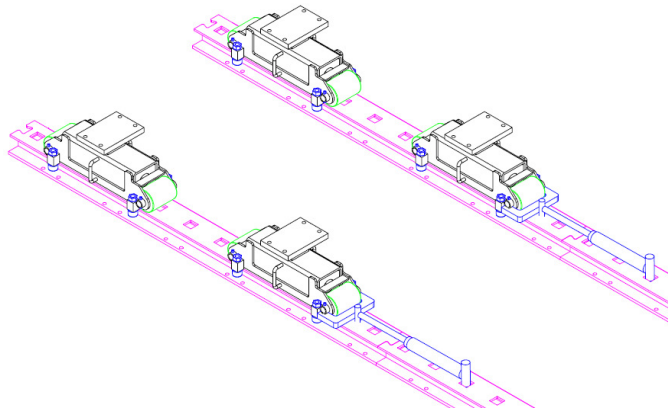

Figure 8: Modular Guide Rails (shown with RR30 rollers and pivot bearings)

Modular Rotation Ring (MRR)

PR15 Heavy Duty Plain Rollers and LB15D Low-Boy Radius Roller can be used on our Modular Rotation Ring (Figure 9) to change the orientation of objects. Standard diameters are 8ft, 10ft and 12ft. Larger, custom diameters are also available upon request. Multiple Modular Rotation Rings of varying diameters can be used for large and/or unbalanced loads. Our signature puzzle lock design permits easy connection and disconnection of the rotation ring rails. The object can be moved with on-site equipment or our JACK ROLL propulsion system which uses hydraulic cylinders. The modular track design allows the Rotation Ring to be broken down into smaller sections for easy transportation and storage.

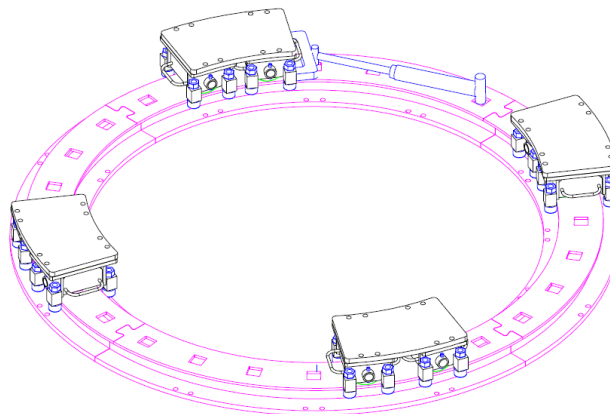

Figure 9: Modular Rotation Ring (shown with PR15 rollers and connector plates)

JACK SYNC Systems



JACK SYNC Power Units allow for quick and easy operation of JACK TRACK and JACK ROLL systems as well as other types of equipment.

Synchronized Power Unit – 10,000 PSI

The 10,000 PSI Synchronized Power Unit (Figure 10) includes the following features:

- Simultaneous or independent operation of 4 hydraulic cylinders
- Dual fuel (gas/propane) for indoor or outdoor use
- Adjustable pressure block
- Specifically designed hose reels to hold 4 hydraulic lines of 30ft in length
- Remote controlled
- Adjustable overhead lifting bar



Figure 10: 10,000 PSI Synchronized Power Unit

Basic Power Unit – 10,000 PSI

The 10,000 PSI Basic Power Unit is gasoline operated for outdoor use only and controls the independent operation of 2 hydraulic cylinders. Propane conversion is available upon request.

Electric Power Unit – 10,000 PSI

The 10,000 PSI Electric Power Unit is available in different voltages. This unit is ideal for indoor use and controls the independent operation of 2 hydraulic cylinders.

Custom Power Units & Hose Reels

Custom JACK SYNC Power Units and Hose Reels can be designed for your specific requirements. Dual fuel conversions are performed in house by a TSSA Certified technician.

Additional Rigging Equipment

Leveling Plates (LP25, LP100)

The LP25 (Figure 11) can be used with the M100 Hydraulic Skidding System support beams and PR15 Heavy Duty Rollers.

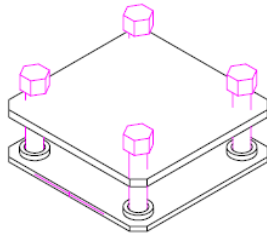

Figure 11: LP25

The LP100 (Figure 12) can be used with the M400 Hydraulic Skidding System support beams and RR30 Heavy Duty Rollers.

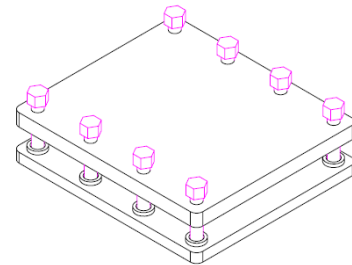

Figure 12: LP100

Load Distribution Plates (LDP25)

LDP25 are used to support the LP25 leveling plate as well as the PR15 and RR30 Heavy Duty Rollers. Easily stackable and hot dipped galvanized for extended life span (Figure 13).

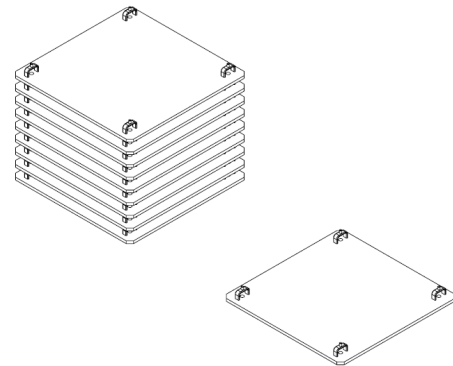

Figure 13: LDP25 load distribution plates

Support Stands (SS)

Support stands are available in a variety of heights (Figure 14). Easily stackable and can be bolted together to increase height. Support stands include connector plates for cross-bracing if required. Support stands are hot dipped galvanized for corrosion protection.

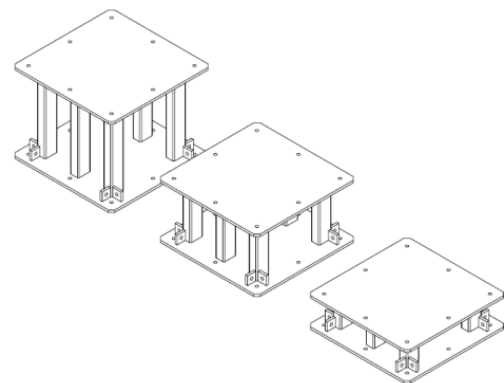

Figure 14: Support stands in varying heights

Structural Mats (STM, SSM)

Structural Steel Mats (SSM) are available in different dimensions and load capacities. Mats can be bolted together. Optional railing system and removable curb system are also available. Hot dipped galvanized finished for corrosion protection. Light weight grid deck options are also available.

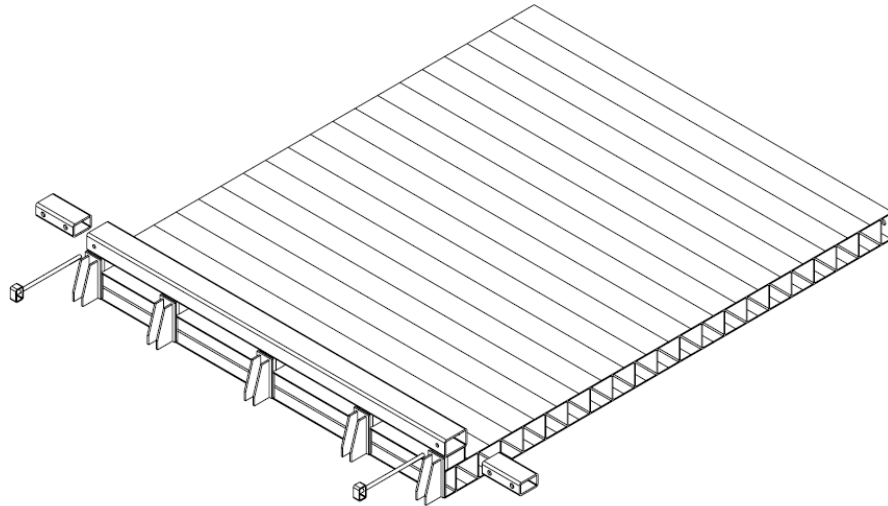

Figure 15: SSM - Structural Steel Mat (shown with optional curb system)

Structural Timber Mats (STM) are available in different dimensions and load capacities. Optional railing system and curb system are also available.

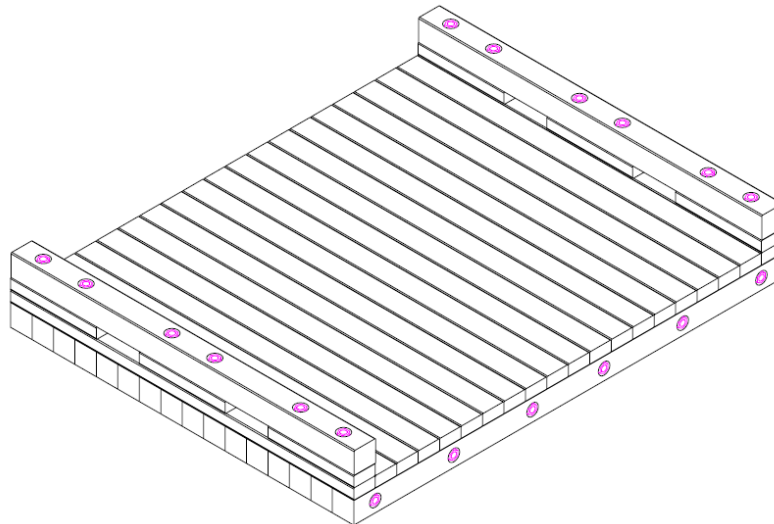

Figure 16: STM - Structural Timber Mat (shown with optional curb system)

Support Timbers (ST)

Support timbers (ST) are available in a range of dimensions and species including hardwood, softwood and Ekki wood. Stackable storage crates are also available.

Shim Kits (SK)

Shim Kits are used to level JACK ROLL, JACK TRACK systems, etc. These kits are available in different sizes, thicknesses and materials specific to your needs.

Pintle Hitch Lock (PHL2535)

The Pintle Hitch Lock (Figure 17) is designed to fit pintle hitches ranging from 2.5" - 3.5" in diameter. This simple device is used to increase security and deter theft of trailers with use of a padlock.

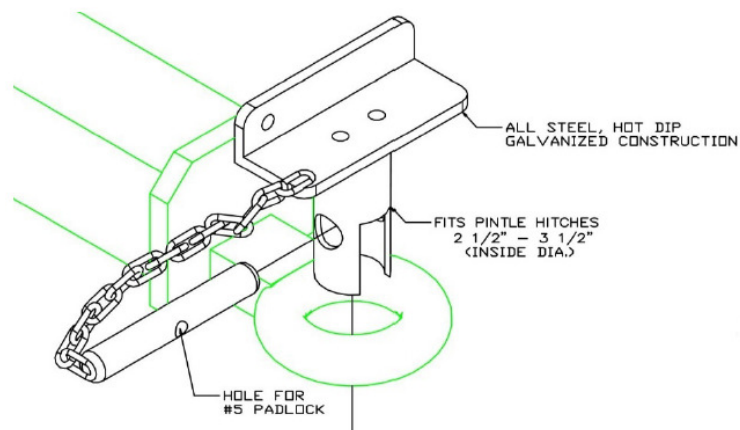

Figure 17: PHL2535 - Pintle Hitch Lock

Storage Solutions

Secured Outdoor Storage

- Short & Long Term storage
- Forklift loading/unloading capabilities
- 100 – 1000 Ton hydraulic skidding system loading/unloading capabilities (subject to availability)
- Tarp or enclosure services
- Crane services (third party)
- Transportation services (third party)

Equipment Rental

In stock demo equipment is available for rent (subject to availability). Please contact us for more information.

Custom Projects

Please contact us to discuss your custom project requirements. Welding procedures and welders are certified to CWB Standard 47.1, which is a CSA standard recognized worldwide.

Disclaimer: This catalogue includes conceptual drawings, which are the intellectual property of HSSI Inc. Physical products may vary in appearance from the drawings included in this catalogue. HSSI Inc. reserves the right to change product details and dimensions without notice. HSSI Inc. has the proprietary rights to all products listed in this catalogue. HSSI Inc. is not responsible for misuse of products resulting in personal injury or damage to property. It is the customer's responsibility to ensure products are loaded safely and within their designed capacities.